

Science Puzzles 10-11

Light, Electricity and Forces

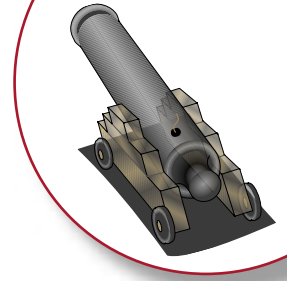

Definition	What's the word?	Answers
A drawing of an electrical circuit.		circuit diagram
A push or a pull.		force
A surface that reflects light so well you can see your reflection.		mirror
The process by which light 'bounces' off a surface.		reflection
Used to turn electricity on or off.		switch
The very weak force that makes all objects attracted each other.		gravity
Anything that will not conduct an electric current is called an _____. Plastics and ceramics are good examples.		insulator
Thin lengths of metal covered in plastic used to make up electrical circuits.		wires
A narrow beam of light.		ray
When something allows light to pass through, it is _____.		transparent
A _____ surface is one that does not reflect light well. A blackboard is a good example.		dull
A measure of the force of gravity on something.		weight
A _____ is an electric cell or series of cells. Used in cars, torches, radios and lots of other things to provide electrical energy.		battery
A measure of the force supplied by a cell in an electric circuit. It has the symbol, V.		voltage
When something does not sink, but sits on the surface of a liquid, it is said to _____.		float
Anything that will conduct an electric current is called a _____. Metals are good examples.		conductor
The electromagnetic energy that we see is called visible _____.		light
The force between magnets or between a magnet and magnetic materials.		magnetism
The force that acts when two objects rub against each other.		friction
A lack of light formed when an object blocks light.		shadow

Teacher's notes - Use this resource sheet in a number of ways:

1. As a worksheet/assessment sheet - Cut off or fold back the answers. Ask the pupils to identify each definition then check their answers against the answer strip.
2. As a reference sheet - Encourage the pupils to use the definitions and answers to design their own crossword or wordsearch on squared paper.